

# Ignition Switch

## Lock Cylinder Replacement

1. Remove the steering wheel, then remove the steering column covers.
2. Remove the bulb/socket from the key light case by turning the socket 45°, then remove the screw and the key light case from the lock body.
3. Turn the ignition key to "I."
4. Push the pin in and remove the lock cylinder from the lock body.

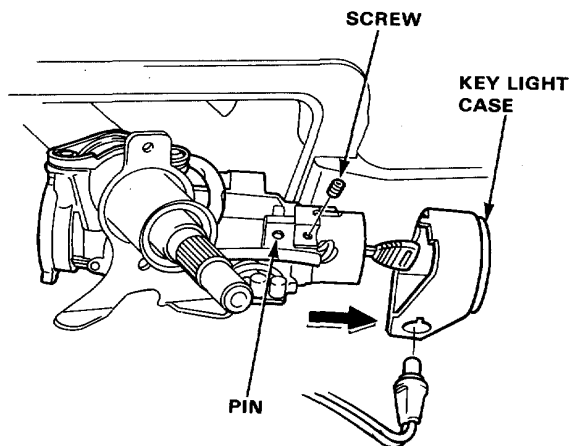

5. Turn the key to "O" and align the lock cylinder with the lock body.
6. Turn the key almost to "I" and insert the lock cylinder until the pin touches the body.
7. Turn the key to the "I", push the pin and insert the lock cylinder into the lock body until the pin clicks into place.

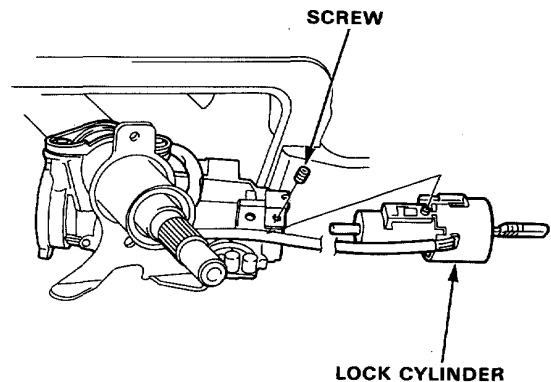



## Steering Lock Replacement

1. Remove the steering wheel, then remove the steering column covers.
2. Remove the instrument panel and the gauge assembly (see page 16-120).
3. Center punch each of the 2 shear bolts and drill their heads off with a 3/16 in. drill bit.

**CAUTION** Do not damage the switch body when removing the shear heads.

4. Remove the shear bolts from the switch body.

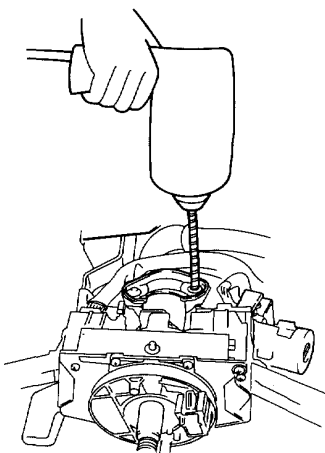

5. Install the new ignition switch without the key inserted.

6. Loosely tighten the new shear bolts.

**NOTE:** Make sure the projection on the ignition switch is aligned with the hole in the steering column.

7. Insert the ignition key and check for proper operation of the steering wheel lock and that ignition key turns freely.

8. Tighten the shear bolts until the hex heads twist off.

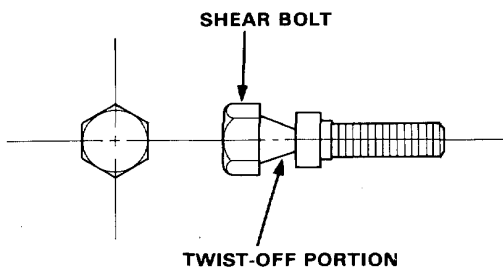

# Starting System

## Component Location Index

**BATTERY**  
Test, page 16-52

**SHIFT POSITION  
CONSOLE SWITCH  
(NEUTRAL SAFETY SWITCH)  
(A/T only)**  
Test, page 16-142  
Replacement, page 16-142

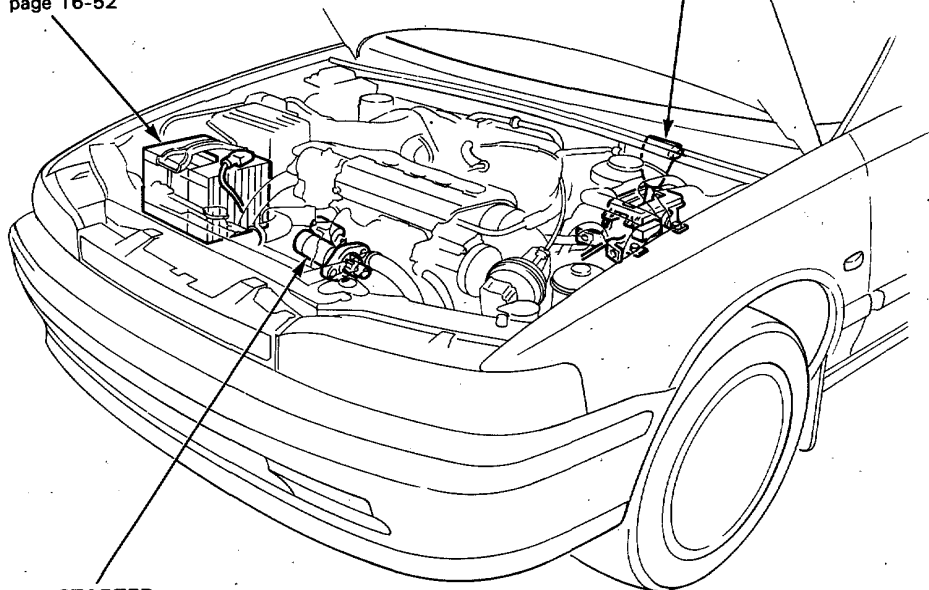

**STARTER**  
Test, page 16-58  
Solenoid Test, page 16-60  
Replacement, page 16-60  
Overhaul, page 16-61, 62  
Reassembly, page 16-67